



Oil separators

with coalescing filter

- 100% recyclable rotomoulded polyethylene tank with lifting rings and manhole(s).
- Vertical automatic stopper in polyethylene calibrated to 0.85.

- Sphère range:**
- PVC inlet and outlet.
 - Light cover (pedestrian traffic) with locking screw.
 - Conical partition.
 - Fully removable coalescing filter.
 - Available as reinforced model (depending on installation limitations).

- Ellipse range:**
- Inlet and outlet with nitrile seals.
 - Polyethylene partition with filter holder and removable coalescing filter.

- Aronde range:**
- PVC inlet and outlet.
 - Polyethylene partition with filter holder and removable coalescing filter.

Sphère

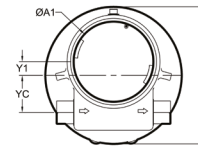
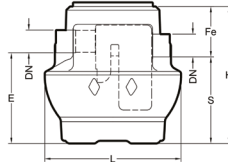

YH20 range	Size l/s	L	P	H	E	S	Fe	DN (PVC Ø)	Weight	Separator Volume	ØA1	Y1	YC	"Fixed" extension option
YH2003E	3	1000	1000	1000	670	640	360	110	37	340	585	100	270	PLA13555G PLA13556G

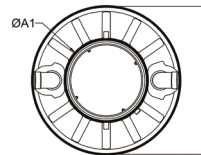
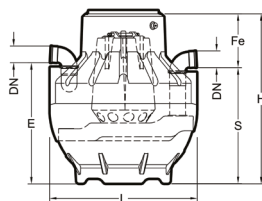

YH20 range	Size l/s	L	P	H	E	S	Fe	DN (PVC Ø)	Weight	Separator Volume	ØA1	"Adjustable" extension option	
YH2010E	10	1500	1500	1700	1200	1150	550	160	88	1520	745	ETR47EF	ETR65EF

Ellipse

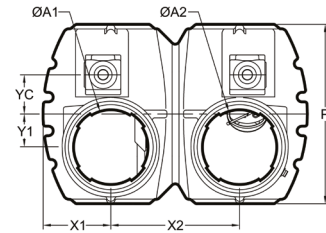
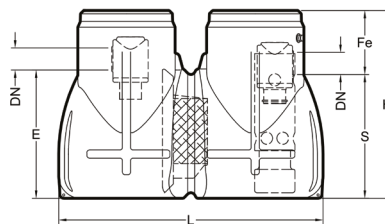

EH20 range	Size l/s	L	P	H	E	S	Fe	DN (PVC Ø)	Weight	Separator Volume	ØA1	ØA2	X1	X2	Y1	YC	"Adjustable" extension option	
EH2020D	20	2400	1624	1700	1160	1120	580	200	229	2900	745	745	615	1170	300	355	ETR47EF	ETR65EF

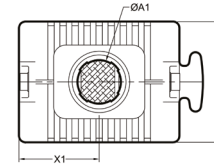
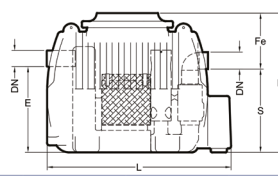

AHFE range	Size l/s	L	P	H	E	S	Fe	DN (PVC Ø)	Weight	Separator Volume	ØA1	X1	"Adjustable" extension option	
AHF130E	30	2295	1500	1730	1085	1065	665	200	187	3100	745	1000	ETR47EF	ETR65EF

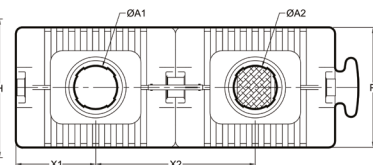
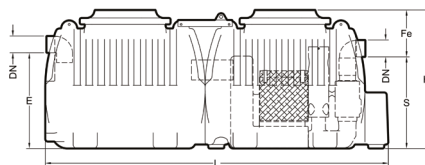

AHFE range	Size l/s	L	P	H	E	S	Fe	DN (PVC Ø)	Weight	Separator Volume	ØA1	ØA2	X1	X2	"Adjustable" extension option	
AHF150E	50	4355	1500	1730	1055	1035	695	315	317	5700	745	745	1000	2000	ETR47EF ETR65EF	

Aronde

options

1. Visual and audible alarm p. 70-71
2. Cylindrical polyethylene extension p.70

	Sphère	Ellipse	Aronde
1.	X	X	X
2.	X	X	X

Dimensions are in millimetres, weights in kilograms, volumes in litres.